

**AERODROME GROUND  
MOVEMENT CHART - ICAO**

APRON ELEV 6 m

TWR	118.8	118.2
GND	121.7	121.75
APRON	121.65	121.8 121.875

**SEOUL / Incheon Intl  
RWY 15L/R, 33L/R DEPARTURE**

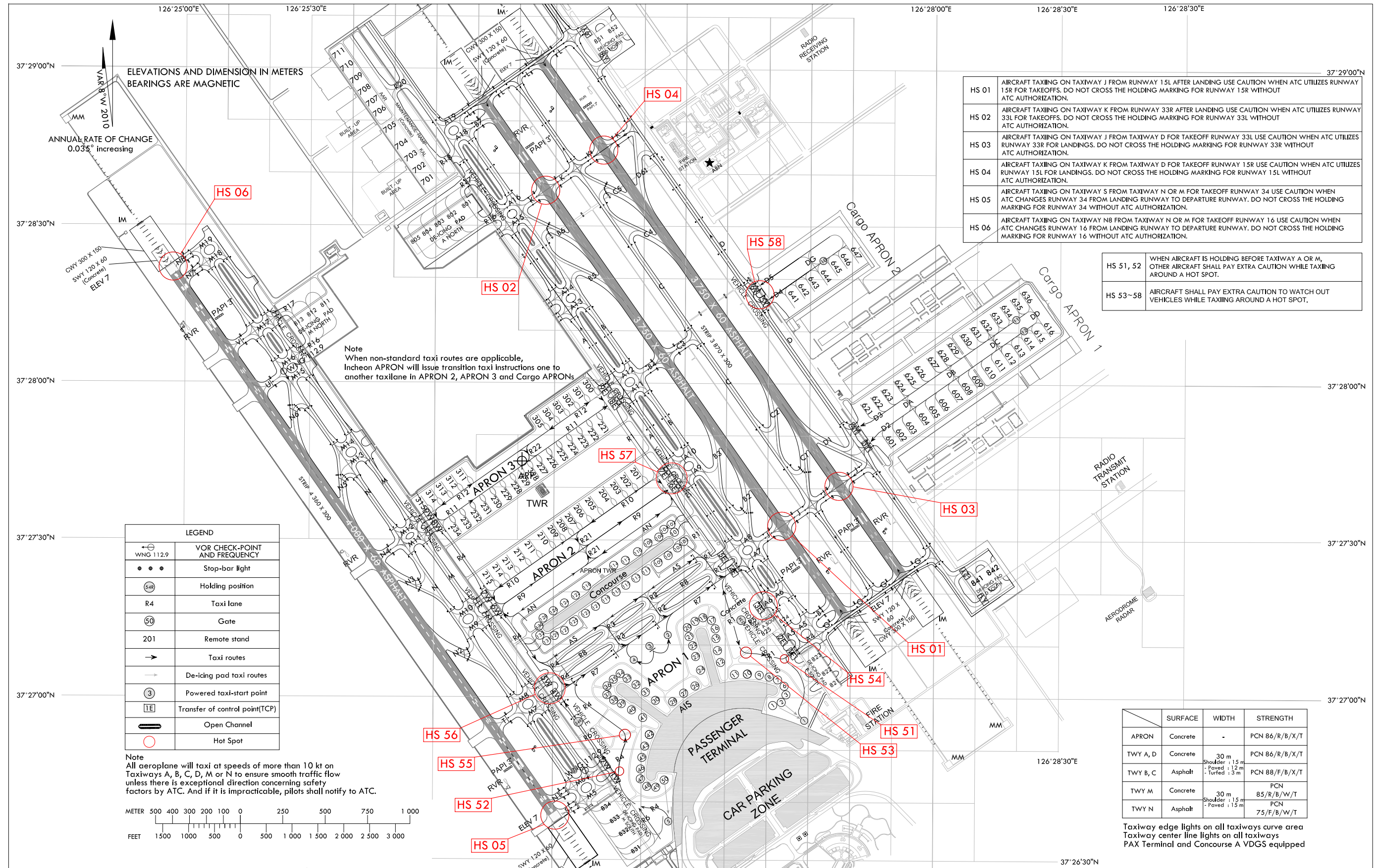

HS 01	AIRCRAFT TAXIING ON TAXIWAY J FROM RUNWAY 15L AFTER LANDING USE CAUTION WHEN ATC UTILIZES RUNWAY 15R FOR TAKEOFFS. DO NOT CROSS THE HOLDING MARKING FOR RUNWAY 15R WITHOUT ATC AUTHORIZATION.
HS 02	AIRCRAFT TAXIING ON TAXIWAY K FROM RUNWAY 33R AFTER LANDING USE CAUTION WHEN ATC UTILIZES RUNWAY 33L FOR TAKEOFFS. DO NOT CROSS THE HOLDING MARKING FOR RUNWAY 33L WITHOUT ATC AUTHORIZATION.
HS 03	AIRCRAFT TAXIING ON TAXIWAY J FROM TAXIWAY D FOR TAKEOFF RUNWAY 33L USE CAUTION WHEN ATC UTILIZES RUNWAY 33R FOR LANDINGS. DO NOT CROSS THE HOLDING MARKING FOR RUNWAY 33R WITHOUT ATC AUTHORIZATION.
HS 04	AIRCRAFT TAXIING ON TAXIWAY K FROM TAXIWAY D FOR TAKEOFF RUNWAY 15R USE CAUTION WHEN ATC UTILIZES RUNWAY 15L FOR LANDINGS. DO NOT CROSS THE HOLDING MARKING FOR RUNWAY 15L WITHOUT ATC AUTHORIZATION.
HS 05	AIRCRAFT TAXIING ON TAXIWAY S FROM TAXIWAY N OR M FOR TAKEOFF RUNWAY 34 USE CAUTION WHEN ATC CHANGES RUNWAY 34 FROM LANDING RUNWAY TO DEPARTURE RUNWAY. DO NOT CROSS THE HOLDING MARKING FOR RUNWAY 34 WITHOUT ATC AUTHORIZATION.
HS 06	AIRCRAFT TAXIING ON TAXIWAY N8 FROM TAXIWAY N OR M FOR TAKEOFF RUNWAY 16 USE CAUTION WHEN ATC CHANGES RUNWAY 16 FROM LANDING RUNWAY TO DEPARTURE RUNWAY. DO NOT CROSS THE HOLDING MARKING FOR RUNWAY 16 WITHOUT ATC AUTHORIZATION.

HS 51, 52	WHEN AIRCRAFT IS HOLDING BEFORE TAXIWAY A OR M, OTHER AIRCRAFT SHALL PAY EXTRA CAUTION WHILE TAXIING AROUND A HOT SPOT.
HS 53-58	AIRCRAFT SHALL PAY EXTRA CAUTION TO WATCH OUT VEHICLES WHILE TAXIING AROUND A HOT SPOT.

**LEGEND**

WNG 112.9	VOR CHECK-POINT AND FREQUENCY
• • •	Stop-bar light
(540)	Holding position
R4	Taxi lane
(50)	Gate
201	Remote stand
→	Taxi routes
→	De-icing pad taxi routes
(3)	Powered taxi-start point
IE	Transfer of control point(TCP)
—	Open Channel
○	Hot Spot

Note  
All aeroplane will taxi at speeds of more than 10 kt on Taxiways A, B, C, D, M or N to ensure smooth traffic flow unless there is exceptional direction concerning safety factors by ATC. And if it is impracticable, pilots shall notify to ATC.

METER 500 400 300 200 100 0 250 500 750 1 000  
FEET 1500 1000 500 0 500 1 000 1 500 2 000 2 500 3 000

	SURFACE	WIDTH	STRENGTH
APRON	Concrete	-	PCN 86/R/B/X/T
TWY A, D	Concrete	30 m Shoulder: 1.5 m Paved: 1.2 m Turfed: 3 m	PCN 86/R/B/X/T
TWY B, C	Asphalt	-	PCN 88/F/B/X/T
TWY M	Concrete	30 m Shoulder: 1.5 m	PCN 85/R/B/W/T
TWY N	Asphalt	-	PCN 75/F/B/W/T

Taxiway edge lights on all taxiways curve area  
Taxiway center line lights on all taxiways  
PAX Terminal and Concourse A VDGs equipped

Change : Amended chart name.

**AERODROME GROUND  
MOVEMENT CHART - ICAO**

APRON ELEV 6 m

TWR	118.8	118.2
GND	121.7	121.75
APRON	121.65	121.8 121.875

**SEOUL / Incheon Intl  
RWY 15L/R, 33L/R ARRIVAL**

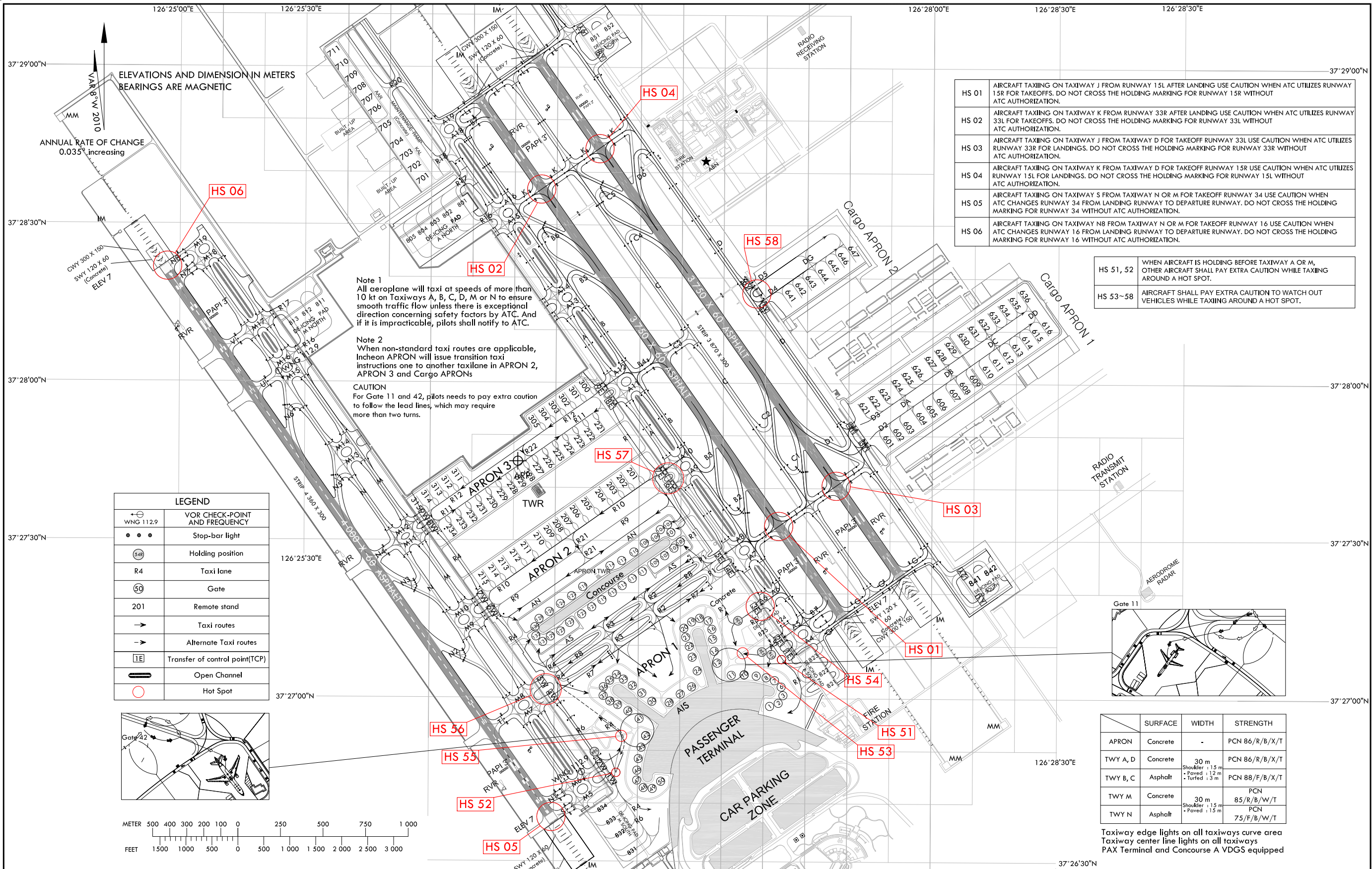

HS 01	AIRCRAFT TAXING ON TAXIWAY J FROM RUNWAY 15L AFTER LANDING USE CAUTION WHEN ATC UTILIZES RUNWAY 15R FOR TAKEOFFS. DO NOT CROSS THE HOLDING MARKING FOR RUNWAY 15R WITHOUT ATC AUTHORIZATION.
HS 02	AIRCRAFT TAXING ON TAXIWAY K FROM RUNWAY 33R AFTER LANDING USE CAUTION WHEN ATC UTILIZES RUNWAY 33L FOR TAKEOFFS. DO NOT CROSS THE HOLDING MARKING FOR RUNWAY 33L WITHOUT ATC AUTHORIZATION.
HS 03	AIRCRAFT TAXING ON TAXIWAY J FROM TAXIWAY D FOR TAKEOFF RUNWAY 33L USE CAUTION WHEN ATC UTILIZES RUNWAY 33R FOR LANDINGS. DO NOT CROSS THE HOLDING MARKING FOR RUNWAY 33R WITHOUT ATC AUTHORIZATION.
HS 04	AIRCRAFT TAXING ON TAXIWAY K FROM TAXIWAY D FOR TAKEOFF RUNWAY 15R USE CAUTION WHEN ATC UTILIZES RUNWAY 15L FOR LANDINGS. DO NOT CROSS THE HOLDING MARKING FOR RUNWAY 15L WITHOUT ATC AUTHORIZATION.
HS 05	AIRCRAFT TAXING ON TAXIWAY S FROM TAXIWAY N OR M FOR TAKEOFF RUNWAY 34 USE CAUTION WHEN ATC CHANGES RUNWAY 34 FROM LANDING RUNWAY TO DEPARTURE RUNWAY. DO NOT CROSS THE HOLDING MARKING FOR RUNWAY 34 WITHOUT ATC AUTHORIZATION.
HS 06	AIRCRAFT TAXING ON TAXIWAY N8 FROM TAXIWAY N OR M FOR TAKEOFF RUNWAY 16 USE CAUTION WHEN ATC CHANGES RUNWAY 16 FROM LANDING RUNWAY TO DEPARTURE RUNWAY. DO NOT CROSS THE HOLDING MARKING FOR RUNWAY 16 WITHOUT ATC AUTHORIZATION.

HS 51, 52	WHEN AIRCRAFT IS HOLDING BEFORE TAXIWAY A OR M, OTHER AIRCRAFT SHALL PAY EXTRA CAUTION WHILE TAXIING AROUND A HOT SPOT.
HS 53-58	AIRCRAFT SHALL PAY EXTRA CAUTION TO WATCH OUT VEHICLES WHILE TAXIING AROUND A HOT SPOT.

LEGEND	
⊕ WNG 112.9	VOR CHECK-POINT AND FREQUENCY
•••	Stop-bar light
(50)	Holding position
R4	Taxi lane
(50)	Gate
201	Remote stand
→	Taxi routes
->	Alternate Taxi routes
IE	Transfer of control point(TCP)
—	Open Channel
○	Hot Spot

	SURFACE	WIDTH	STRENGTH
APRON	Concrete	-	PCN 86/R/B/X/T
TWY A, D	Concrete	30 m	PCN 86/R/B/X/T
TWY B, C	Asphalt	Shoulder : 1.5 m Paved : 1.2 m Turfed : 3 m	PCN 88/F/B/X/T
TWY M	Concrete	30 m	PCN 85/R/B/W/T
TWY N	Asphalt	Shoulder : 1.5 m Paved : 1.5 m	PCN 75/F/B/W/T

Taxiway edge lights on all taxiways curve area  
Taxiway center line lights on all taxiways  
PAX Terminal and Concourse A VDGs equipped

Change : Amended chart name.

**AERODROME GROUND  
MOVEMENT CHART - ICAO**

APRON ELEV 6 m

TWR	118.8	118.2
GND	121.7	121.75
APRON	121.65	121.8 121.875

**SEOUL / Incheon Intl  
RWY 16, 34 DEPARTURE**

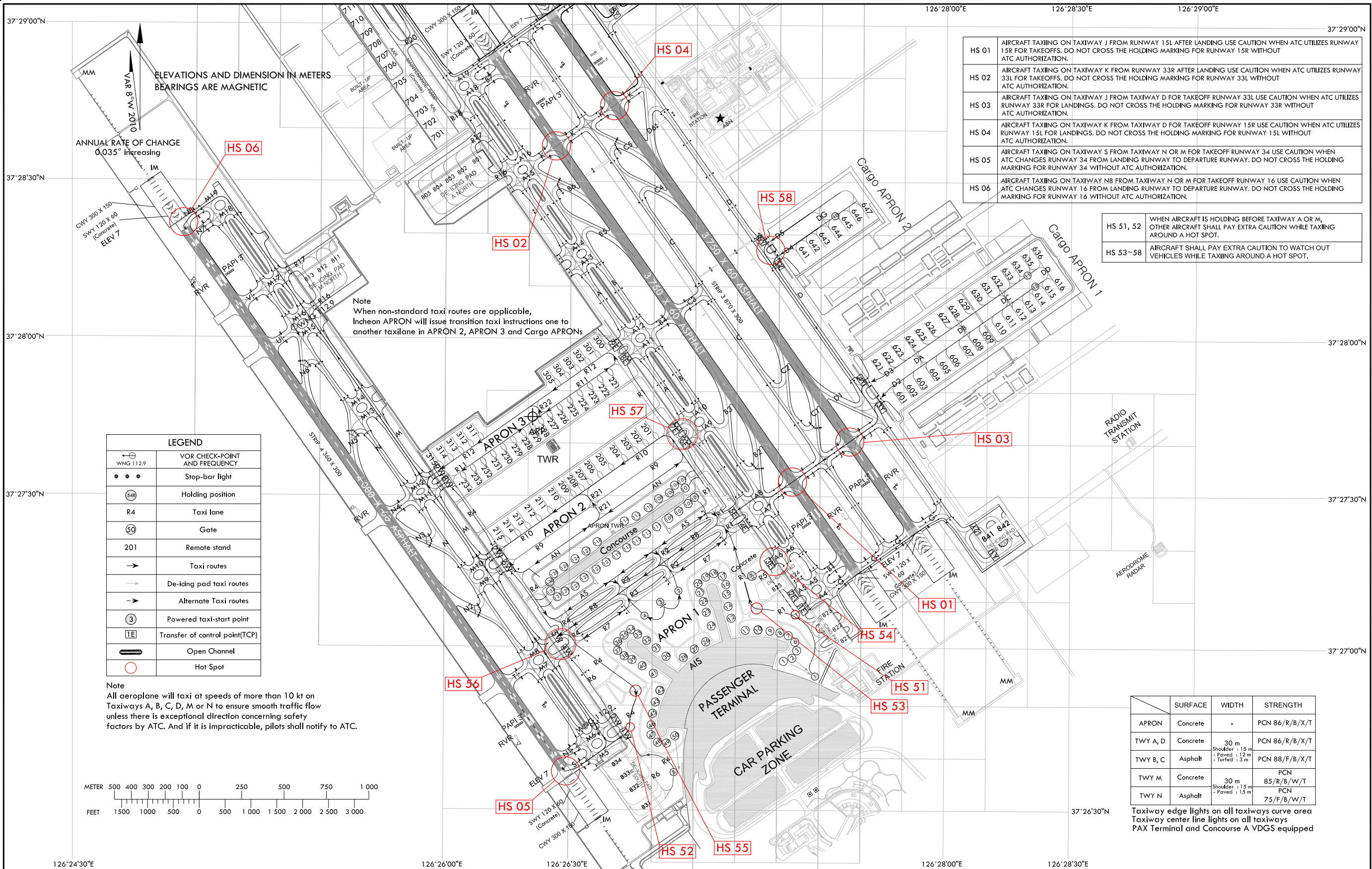

ELEVATIONS AND DIMENSION IN METERS  
BEARINGS ARE MAGNETIC

ANNUAL RATE OF CHANGE  
0.035° Increasing

Note  
When non-standard taxi routes are applicable,  
Incheon APRON will issue transition taxi instructions one to  
another taxilane in APRON 2, APRON 3 and Cargo APRONS

LEGEND	
	VOR CHECK-POINT AND FREQUENCY
	Stop-bar light
	Holding position
	Taxi lane
	Gate
	Remote stand
	Taxi routes
	De-icing pad taxi routes
	Alternate Taxi routes
	Powered taxi-start point
	Transfer of control point(TCP)
	Open Channel
	Hot Spot

Note  
All aeroplane will taxi at speeds of more than 10 kt on  
Taxiways A, B, C, D, M or N to ensure smooth traffic flow  
unless there is exceptional direction concerning safety  
factors by ATC. And if it is impracticable, pilots shall notify to ATC.



HS 01	AIRCRAFT TAXIING ON TAXIWAY J FROM RUNWAY 15L AFTER LANDING USE CAUTION WHEN ATC UTILIZES RUNWAY 15R FOR TAKEOFFS. DO NOT CROSS THE HOLDING MARKING FOR RUNWAY 15R WITHOUT ATC AUTHORIZATION.
HS 02	AIRCRAFT TAXIING ON TAXIWAY K FROM RUNWAY 33R AFTER LANDING USE CAUTION WHEN ATC UTILIZES RUNWAY 33L FOR TAKEOFFS. DO NOT CROSS THE HOLDING MARKING FOR RUNWAY 33L WITHOUT ATC AUTHORIZATION.
HS 03	AIRCRAFT TAXIING ON TAXIWAY J FROM TAXIWAY D FOR TAKEOFF RUNWAY 33L USE CAUTION WHEN ATC UTILIZES RUNWAY 33R FOR LANDINGS. DO NOT CROSS THE HOLDING MARKING FOR RUNWAY 33R WITHOUT ATC AUTHORIZATION.
HS 04	AIRCRAFT TAXIING ON TAXIWAY K FROM TAXIWAY D FOR TAKEOFF RUNWAY 15R USE CAUTION WHEN ATC UTILIZES RUNWAY 15L FOR LANDINGS. DO NOT CROSS THE HOLDING MARKING FOR RUNWAY 15L WITHOUT ATC AUTHORIZATION.
HS 05	AIRCRAFT TAXIING ON TAXIWAY S FROM TAXIWAY N OR M FOR TAKEOFF RUNWAY 34 USE CAUTION WHEN ATC CHANGES RUNWAY 34 FROM LANDING RUNWAY TO DEPARTURE RUNWAY. DO NOT CROSS THE HOLDING MARKING FOR RUNWAY 34 WITHOUT ATC AUTHORIZATION.
HS 06	AIRCRAFT TAXIING ON TAXIWAY N8 FROM TAXIWAY N OR M FOR TAKEOFF RUNWAY 16 USE CAUTION WHEN ATC CHANGES RUNWAY 16 FROM LANDING RUNWAY TO DEPARTURE RUNWAY. DO NOT CROSS THE HOLDING MARKING FOR RUNWAY 16 WITHOUT ATC AUTHORIZATION.

HS 51, 52	WHEN AIRCRAFT IS HOLDING BEFORE TAXIWAY A OR M, OTHER AIRCRAFT SHALL PAY EXTRA CAUTION WHILE TAXIING AROUND A HOT SPOT.
HS 53-58	AIRCRAFT SHALL PAY EXTRA CAUTION TO WATCH OUT VEHICLES WHILE TAXIING AROUND A HOT SPOT.

	SURFACE	WIDTH	STRENGTH
APRON	Concrete	-	PCN 86/R/B/X/T
TWY A, D	Concrete	30 m	PCN 86/R/B/X/T
TWY B, C	Asphalt	Shoulder : 1.5 m - Paved : 1.2 m - Turfed : 3 m	PCN 88/F/B/X/T
TWY M	Concrete	30 m	PCN 85/R/B/W/T
TWY N	Asphalt	Shoulder : 1.5 m - Paved : 1.5 m	PCN 75/F/B/W/T

Taxiway edge lights on all taxiways curve area  
Taxiway center line lights on all taxiways  
PAX Terminal and Concourse A VDGs equipped

**AERODROME GROUND  
MOVEMENT CHART - ICAO**

APRON ELEV 6 m

TWR	118.8	118.2
GND	121.7	121.75
APRON	121.65	121.8 121.875

**SEOUL / Incheon Intl  
RWY 16, 34 ARRIVAL**

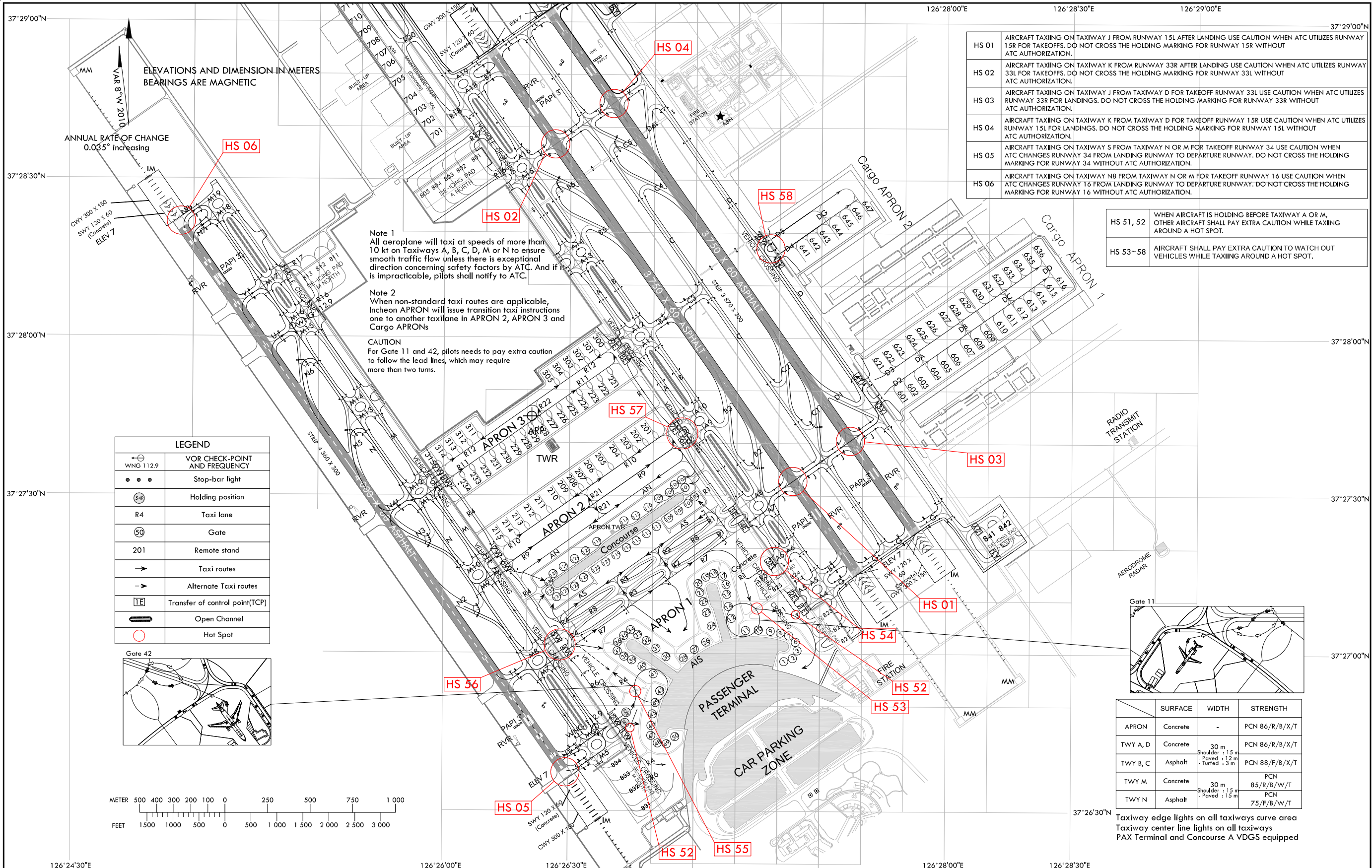

HS 01	AIRCRAFT TAXIING ON TAXIWAY J FROM RUNWAY 15L AFTER LANDING USE CAUTION WHEN ATC UTILIZES RUNWAY 15R FOR TAKEOFFS. DO NOT CROSS THE HOLDING MARKING FOR RUNWAY 15R WITHOUT ATC AUTHORIZATION.
HS 02	AIRCRAFT TAXIING ON TAXIWAY K FROM RUNWAY 33R AFTER LANDING USE CAUTION WHEN ATC UTILIZES RUNWAY 33L FOR TAKEOFFS. DO NOT CROSS THE HOLDING MARKING FOR RUNWAY 33R WITHOUT ATC AUTHORIZATION.
HS 03	AIRCRAFT TAXIING ON TAXIWAY J FROM TAXIWAY D FOR TAKEOFF RUNWAY 33L USE CAUTION WHEN ATC UTILIZES RUNWAY 33R FOR LANDINGS. DO NOT CROSS THE HOLDING MARKING FOR RUNWAY 33R WITHOUT ATC AUTHORIZATION.
HS 04	AIRCRAFT TAXIING ON TAXIWAY K FROM TAXIWAY D FOR TAKEOFF RUNWAY 15R USE CAUTION WHEN ATC UTILIZES RUNWAY 15L FOR LANDINGS. DO NOT CROSS THE HOLDING MARKING FOR RUNWAY 15L WITHOUT ATC AUTHORIZATION.
HS 05	AIRCRAFT TAXIING ON TAXIWAY S FROM TAXIWAY N OR M FOR TAKEOFF RUNWAY 34 USE CAUTION WHEN ATC CHANGES RUNWAY 34 FROM LANDING RUNWAY TO DEPARTURE RUNWAY. DO NOT CROSS THE HOLDING MARKING FOR RUNWAY 34 WITHOUT ATC AUTHORIZATION.
HS 06	AIRCRAFT TAXIING ON TAXIWAY N8 FROM TAXIWAY N OR M FOR TAKEOFF RUNWAY 16 USE CAUTION WHEN ATC CHANGES RUNWAY 16 FROM LANDING RUNWAY TO DEPARTURE RUNWAY. DO NOT CROSS THE HOLDING MARKING FOR RUNWAY 16 WITHOUT ATC AUTHORIZATION.

HS 51, 52	WHEN AIRCRAFT IS HOLDING BEFORE TAXIWAY A OR M, OTHER AIRCRAFT SHALL PAY EXTRA CAUTION WHILE TAXIING AROUND A HOT SPOT.
HS 53-58	AIRCRAFT SHALL PAY EXTRA CAUTION TO WATCH OUT VEHICLES WHILE TAXIING AROUND A HOT SPOT.

**Note 1**  
All aeroplane will taxi at speeds of more than 10 kt on Taxiways A, B, C, D, M or N to ensure smooth traffic flow unless there is exceptional direction concerning safety factors by ATC. And if it is impracticable, pilots shall notify to ATC.

**Note 2**  
When non-standard taxi routes are applicable, Incheon APRON will issue transition taxi instructions one to another taxiway in APRON 2, APRON 3 and Cargo APRONS

**CAUTION**  
For Gate 11 and 42, pilots needs to pay extra caution to follow the lead lines, which may require more than two turns.

**LEGEND**

WNG 112.9	VOR CHECK-POINT AND FREQUENCY
•••	Stop-bar light
(S)	Holding position
R4	Taxi lane
(G)	Gate
201	Remote stand
→	Taxi routes
->	Alternate Taxi routes
TE	Transfer of control point(TCP)
—	Open Channel
○	Hot Spot

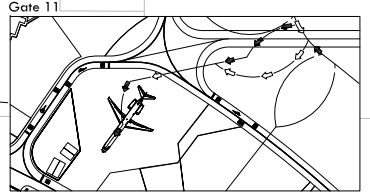
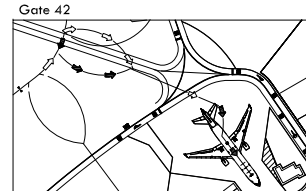

	SURFACE	WIDTH	STRENGTH
APRON	Concrete	-	PCN 86/R/B/X/T
TWY A, D	Concrete	30 m	PCN 86/R/B/X/T
TWY B, C	Asphalt	Shoulder : 15 m Paved : 12 m Turfed : 3 m	PCN 88/F/B/X/T
TWY M	Concrete	30 m	PCN 85/R/B/W/T
TWY N	Asphalt	Shoulder : 15 m Paved : 15 m	PCN 75/F/B/W/T

Taxiway edge lights on all taxiways curve area  
Taxiway center line lights on all taxiways  
PAX Terminal and Concourse A VDGS equipped

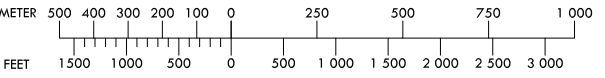

Change : Amended chart name.